

DARWIN FESTIVAL

7-24 AUGUST 2025

City of Darwin Teddy Bears' Picnic Access Guide

Proudly supported by



Introduction



Image Description: A large teddy bear in a red checkered vest sits on grass, surrounded by smaller stuffed animals at an outdoor event.

The City of Darwin Teddy Bears' Picnic is a morning jam-packed with activities for children and families.

In 2025, activities will include:

- The magical world of Nylon Zoo, where our littlest creatives can dress up as their favourite animals, parade with their pack and explore giant inflatable habitats.
- *Little Ravers Disco* (bubbles! confetti! bangers!)
- DJ Guru Dudu's joyful silent disco
- Face painting
- Interactive art
- Baby Ballerinas with their teddy bears
- A huge range of fun-filled stalls for kids to explore

All activities are free and you do not need a ticket to attend.

Location

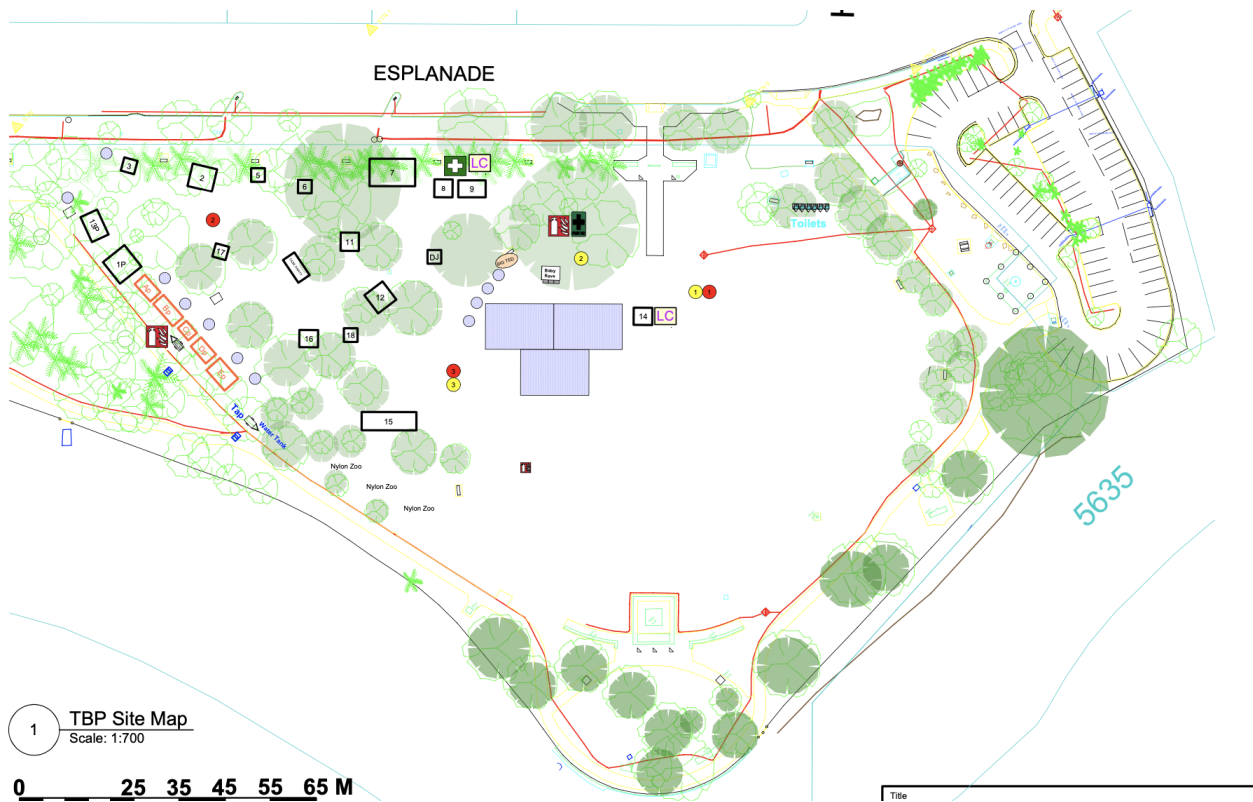

Image Description: A labeled site map shows buildings, pathways, trees, and parking areas, with symbols marking key features.

The Teddy Bears' Picnic takes place at the Darwin Cenotaph War Memorial, where Herbert Street meets The Esplanade in Darwin CBD. It is behind Parliament House.



Image Description: A sunny open park with scattered trees, a brick pathway, and a single street lamp under a clear blue sky.

This is how the location looks when the Teddy Bears' Picnic is not there.

Most of the activities take place in the shade but we still recommend you bring a hat, sunscreen and water.

The location is wheelchair accessible, but may be uneven as it is on grass.

Parking



Image Description: A sunny parking lot with several cars parked under trees, including palm trees, with clear blue sky overhead.

There is limited parking available at Darwin Oval Car Park, which turns off The Esplanade.

There is a short walk from the car park to the Teddy Bears' Picnic.

Parking is free on weekends.



Image Description: A sunny street lined with tall streetlights, green trees, and parked cars, under a clear blue sky.

Street parking is available along the Esplanade, including accessible bays.

Please note: the road on the Esplanade between Herbert Street and Knuckey Street will be closed from 5:30 AM to 2:00 PM. 

There is a short walk from the car parks to the Teddy Bears' Picnic, along a cycle path.

Parking is free on the weekend.

The closest multi-storey parking is the West Lane Car Park, located at 6 West Lane Darwin City.

Toilets



Image Description: A metal public toilet structure with signage, set outdoors near trees and parked cars.

There is a public, accessible toilet located near the Darwin Oval Car Park.

Further public toilets are spread out along the Esplanade.

For the Teddy Bears' Picnic, there will be lots of portaloos available.

Activities



Image Description: A group of people, including children in costumes, gather in a shaded park

There will be lots of activities taking place at the same time, and lots of children and adults attending.

This means it may feel crowded and there will be lots of noise.



Image Description: At a crowded outdoor event, two people in green shirts point at something off-camera, with a child in the foreground

You may need to line up to join in some activities. There will be signs telling you to do so.



Image Description: A person holds a child amid floating bubbles at a picnic event, with a partially visible "City of Darwin Teddy Picnic" sign in the background.



Image Description: At an outdoor event under a large tree, a person in a colorful outfit raises their arms near a stage with a "Teddy Bears' Picnic" banner and a DJ setup.

Some activities may stimulate your senses through touch, bright colours, loud sounds and music.



Image Description: A person holds a child next to someone in a large fish costume, with another child nearby in a park setting.

Some people may be dressed up in costumes and pretend to be different characters.

They may try to speak to you, but you can tell them 'no, thank you' if you prefer not to speak to them.

Food and drinks



Image Description: People gather around shaded food stalls labeled "Ken's Crepes" and "Popcorn" in a park-like setting.

Food and drinks are available to purchase. Please check with the food stall to see if they accept cash or card.

There may be lines to purchase food and drinks.

You are welcome to bring your own food and drinks.

Assistance



Image Description: Four people in green uniforms stand in front of an ambulance, with two holding stuffed animals—a purple teddy bear and a blue monkey.

St John's Ambulance Service will be there to provide First Aid. If you feel unwell, they will be happy to help you.



Image Description: A person in a green "VOLUNTEER" shirt and wide-brimmed hat stands in a park during a busy outdoor event.

As always, our friendly volunteers will be there to help with anything you need!

This year, they will be wearing light green/teal shirts.

Access Program proudly supported by

